

### Straight Sections and Waveguide Bends Series

**ETG-Canteq** supplies simple flanged straight pieces of waveguide and combinations of rigid and flexible waveguide including 90 degree "E" and "H" Bends. Integrated assemblies are built to customer specifications and they are available in waveguide sizes from WR284 to WR28. Ordinary waveguide components are underestimated by many manufacturers. At **ETG-Canteq** we take at heart these simple components and we use the latest in passivation and cleaning processes in order to make sure that your waveguide joints will not deteriorate and that corrosion

due to poor cleaning and passivation will not occur. We use Oxygen Free Copper waveguide that reaches minimum conductivity of 97.6 which means low insertion loss and great performance. All of this may sound expensive. **How about price?**

**ETG-Canteq** will offer you all the above quality materials and workmanship at the lowest price in the industry. By the way, we forgot to mention that included in our low pricing there is **Silver Solder** for every joint and flange of our waveguide components. **No soft solder is used.**

#### STRAIGHT AND TWIST SECTIONS

Model No Straight	Model No TWIST	W/G (WR)	Minimum Length Straight	Minimum Length TWIST
C1161-1	C1171-1	284	3.00"	9.25"
C1161-2	C1171-2	229	3.00"	8.00"
C1161-3	C1171-3	187	3.00"	7.00"
C1161-4	C1171-4	159	3.00"	6.00"
C1161-5	C1171-5	137	3.00"	6.00"
C1161-6	C1171-6	112	2.00"	3.75"
C1161-7	C1171-7	90	2.00"	2.75"
C1161-8	C1171-8	75	2.00"	2.25"
C1161-9	C1171-9	62	1.00"	2.00"
C1161-10	C1171-10	51	1.00"	1.50"
C1161-11	C1171-11	42	1.00"	1.25"

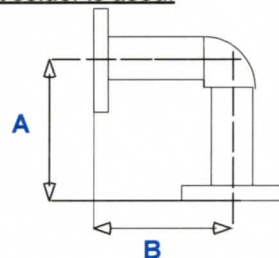
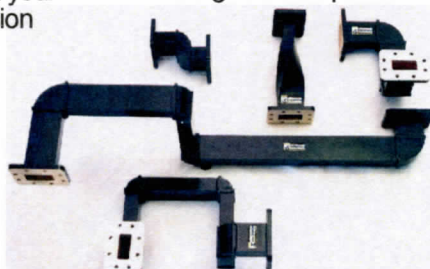

#### C1181 CAST BEND and C1182 SWEPT BEND

Model No Cast Bend	Model No Swept Bend	W/G (WR)	Freq. Range* (GHz)	Dimension A & B	
			CAST		SWEPT
C1181-1	C1182-1	284	2.60-3.95	3.75"	10.00"
C1181-2	C1182-2	229	3.30-4.90	3.00"	9.00"
C1181-3	C1182-3	187	3.95-5.85	2.75"	8.50"
C1181-4	C1182-4	159	4.90-7.05	2.75"	6.00"
C1181-5	C1182-5	137	5.85-8.20	2.00"	5.00"
C1181-6	C1182-6	112	7.05-10.00	2.00"	4.00"
C1181-7	C1182-7	90	8.20-12.40	1.75"	2.00"
C1181-8	C1182-8	75	10.00-15.00	1.50"	1.50"
C1181-9	C1182-9	62	12.40-18.00	1.50"	1.50"
C1181-10	C1182-10	51	15.00-22.00	1.25"	1.50"
C1181-11	C1182-11	42	18.00-26.50	1.00"	1.50"

\* For better performance, please specify your operating frequency

#### How to order the right part:

a) Straight sections

**ETG-Canteq** Model No  
**C1161-5-30-2-2** is:

Model No	Length	Flanges
C1161-5	30	2-2

a WR137 having a and CPRF straight wave-length of flanges at guide section. 30 inches both ends.



FLANGE CODE	American (EIA standard)		European (IEC standard)	
	Code	Flange	Code	Flange
1	CPR-G		21	PDR - Grooved
2	CPR-F		22	UDR - Rectangular Flat
3	CMR Standard 4clear/4tapped		24	UER - Clear Holes
4	CMR 8 clear holes		26	UBR - Square Flat
5	CMR 8 tapped holes		27	PBR - Square Grooved
6	UG Cover		8	Special: "Specify"
7	UG Groove		8	Special: "Specify"
8	Special: "Specify"		29	CBR - Square Choke
9	Choke -Square		30	UAR70-UAR32-Round Plain
10	Cover Round-F (WR137-284)		31	PAR70-PAR32-Round Grooved
11	Cover Round-G (WR137-284)		32	CAR70-CAR32-Round Choke
12	Cover Round-G (WR137-284)			